

PLEASE READ INSTRUCTIONS CAREFULLY BEFORE STARTING INSTALLATION

Before starting, please exercise all safety precautions with any tools/chemicals/other devices that you use during installation. If you encounter any unfamiliar tasks during installation, we recommend that you allow an experienced professional to complete the installation. By attempting to install or installing this product, Fore Precision Works, LLC does not accept responsibility for personal injury or property damage. If you encounter any questions or concerns during installation, please contact your retailer.

REQUIRED FOR INSTALLATION:

2.5mm hex key (Allen wrench)

If there is a fitment problem, you will need the following items:

1. File
2. Masking tape (for protecting hood paint during test fits)
3. Vacuum cleaner or wet rag (to clean fiberglass dust)

REFERENCE THE FOLLOWING ITEMS IN THESE INSTRUCTIONS:

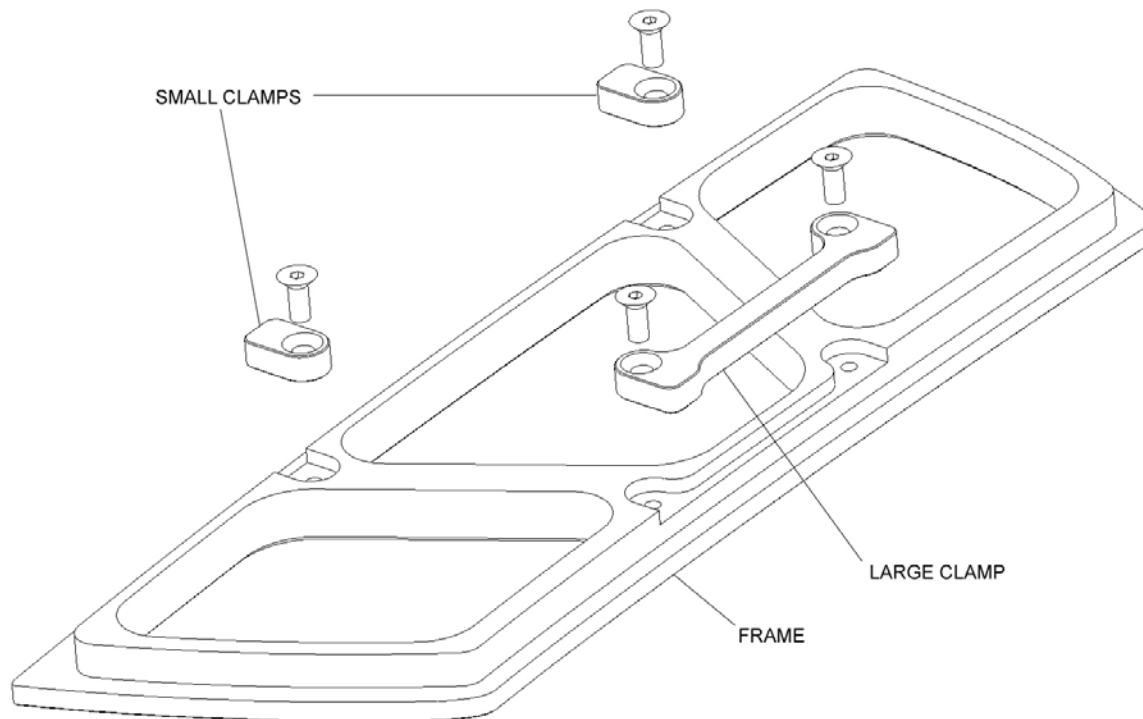

REMOVE THE FACTORY HEAT EXTRACTOR VENT GRILLES:

1. Open hood and disconnect battery.
2. Remove hood blanket. (don't forget to disconnect the ground wire on the passenger side by the firewall)
3. Unsnap and remove the plastic factory heat extractor vent grilles. No tools are required for this operation. Use caution, as the factory grilles have steel clips that could scratch the paint.

INSTALL FPW HEAT EXTRACTOR VENT FRAMES:

USE CAUTION: The openings in the factory '03-'04 Mustang Cobra hoods are hand cut with loose tolerances. There is a possibility that you may have to lightly enlarge this opening for a proper fit.

1. Remove the small clamps and the large clamp (per side) and test fit the frame in the hood. If the frame does not fall into place, **DO NOT FORCE**, or you will scratch the paint. If the frames fall into position, proceed to step 2.

ONLY IF THE FRAMES DO NOT FIT:

If you are uncomfortable with the following procedure and you cannot find someone who is experienced to help, please return the FPW heat extractor vents for a full refund.

Apply masking tape in the areas needed to protect the hood paint. The frame's anodizing is very hard and will easily chip the paint. Gently file the edges of the opening in the hood in the proper locations until the frame drops into place. Remove the masking tape and vacuum dust before proceeding.

2. Clean sand/dirt where frame installs in the recess in the hood. Place frames into position.
3. Install the large and small clamps and tighten screws until tight. As you tighten the screws, ensure that the rubber balls are the only part of the clamp making contact with the hood. The clamp should feel spring loaded from the rubber ball, but if you feel any binding, stop and check for interference. Do not risk cracking the hood! The rubber balls that are pressed in the clamps should be contacting the fiberglass hood and will offer some compensation since the thickness of the hood is not very consistent around the clamping area.
4. Close the hood, but do not latch. It should be possible to slightly move the FPW heat extractor vents frames in the hood recess with some resistance. The goal of this step is to determine whether the FPW heat extractor vent frames are "soft clamping" the hood with the rubber balls. The goal is to have a compensated fit that would not vibrate nor stress the fiberglass around the clamps.
5. Reinstall the hood blanket.
6. Reconnect the battery.
7. Account for all tools and close the hood.

FOR QUICK REMOVAL AND INSTALLATION (CLEANING/WAXING PURPOSES)

If you choose to operate your vehicle without the hood blanket, you may expedite removal and installation of the FPW heat extractor vent frames by completely removing the two small clamps and only loosening the screws on the large clamp. (do not remove) Take extra care during removal and installation, as the anodized aluminum can easily damage your paint with hard contact.

CLEANING INSTRUCTIONS

Acidic or alkaline cleaners (such as commercial wheel cleaners) can damage the anodized finish. For best results, clean with the same mild detergent or automotive shampoo that you use on your car's paint. Rinse immediately. If possible, avoid cleaning when hot from sunlight and/or engine heat.

If you are unsatisfied with this product in any way, please contact your retailer for a replacement or refund.

Fore Precision Works, LLC
support@foreprecisionworks.com